

130 Sliding Window

Features:

- **DP Rating R50** (window size tested 74" x 50" for 2-Lite and 108" x 50" for 3-Lite)
- **DP Rating 40** (window size tested 74" x 63" 2-Lite)
- **DP Rating 30** (window size tested 108" x 63")
- Step Bevel design creates a beautiful exterior appearance
- Tandom rollers ride easily along friction free channel
- Integrated glide rail for easy sash opening and closing
- Warm-Edge spacer system provides energy saving thermal performance
- Aluminum reinforcement standard
- Dual sweep locks
- Dual weather-stripping
- Step sill design
- Fiberglass half screen
- Jamb depth: 3"
- Limited lifetime warranty

Custom Options:

- **SELECT FROM FOUR FRAME TYPES:**
Front Flange Only, Nail Fin Only (No J-Channel), J-Channel (Nail Fin & Front Flange), Box Frame (No Nail Fin & No Front Flange)
- Low-E Glass, Low-E Glass + Argon Gas and Ultra Low-E Glass + Argon Gas
- 5/8" or 3/4" flat, 5/8" or 1" contoured and 1 1/8" simulated divided lite (SDL) grids.
- Colonial, Diamond, Prairie (8 point) grid patterns.
- Charcoal aluminum half screen
- Non-reflective Low-E Glass and Non-reflective Low-E Glass with Argon Gas
- Double strength and obscure glass
- Commodity sizing available for Front Flange Only model
- Nine Exterior Painted Colors (white interior only)
- Bronze Exterior Laminate (white interior only)
- Custom sizes available

Product Performance:

AAMA 101 Results:

Window Size	AAMA Rating (psf)	Air (cfm/ft ²)	Water (psf)
74" x 50" (O/X)	HS-LC50	0.02	7.52
74" x 63" (O/X)	HS-LC35	0.02	7.52
108" x 50" (X/O/X)	HS-LC50	0.08	7.52
108" x 63" (X/O/X)	HS-LC30	0.08	7.52

Product Dimensions:

Vinyl Wall Thickness:	0.060"
Typ. Glass Thickness:	0.75"
Jamb Depth:	3"
Mullion Adder:	1.25"
Nail Fin Setback:	1.9375"
Front Flange:	0.625"

Rough Opening:

Window Width + 1/2"
Window Height + 1/2"

2-Lite Slider Size Restrictions:

	Min:	Max:
Width	23 1/2"	74"
Height	11 1/2"	72"

3-Lite Slider Size Restrictions:

	Min:	Max:
Width	71 1/2"	108"
Height	11 1/2"	63"



130 2-lite slider with front flange

130 Sliding Window

Egress Formulas:

Egress Width $\geq 20"$ and Egress Height $\geq 24"$ and Egress Area $\geq 5.7 \text{ ft}^2$ required to meet egress.

Egress Width Formula = $XO/OX = (\text{window width}/2) - 3.75"$

XOX 1/3 1/3 1/3 = $(\text{window width}/3) - 3.3125"$

XOX 1/4 1/2 1/4 = $(\text{window width}/4) - 3.875"$

Egress Height Formula = $(\text{Window Height}) - 5.00"$

Egress Area Formula = $(\text{Egress Width} \times \text{Egress Height})/144$

Screen Formulas:

Width: $XO/OX = (\text{window width}/2) - 3.00"$

XOX 1/3 1/3 1/3 = $(\text{window width}/3) - 2.5625"$

XOX 1/4 1/2 1/4 = $(\text{window width}/4) - 3.125"$

Height: $\text{window height} - 3.875"$

Series 130 Horizontal Diagram

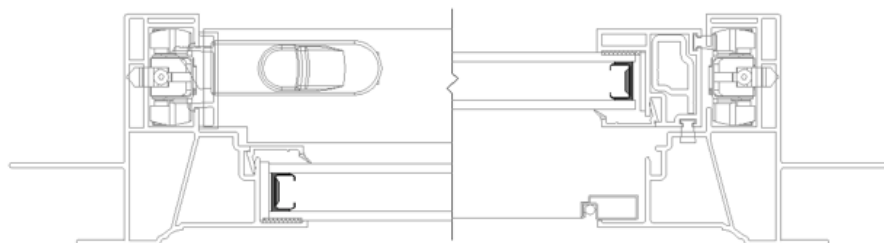

Series 130 Vertical Diagram

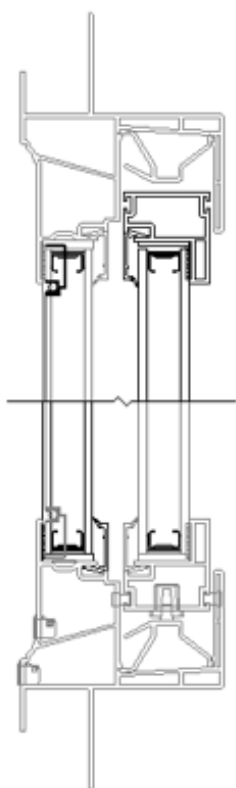

Series 130 Horizontal Diagrams

