

151/161 2 and 3-Lite Sliding Window

Features:

- Beautiful, true brick mould exterior frame perimeter
- Aluminum-reinforced lock rail and meeting rails add strength
- Tandem rollers ride easily along friction free glide channel
- Available in XO or OX configurations (sliding panel on left or right)
- Integrated J-channel (Series 161 available without J-channel)
- Pre-punched nail fin simplifies installation
- Insulated glass panels featuring warm-edge spacer system
- 2-lite and 3-lite configurations available
- Half screen comes standard
- Charcoal fiberglass mesh screen
- Jamb depth: 3.277"
- Limited lifetime warranty

Custom Options:

- Low-E Glass
- Low-E Glass + Argon Gas
- Ultra Low-E Glass + Argon Gas
- 5/8" or 3/4" flat, 5/8" or 1" contoured, 1 1/8" simulated divided lite (SDL), 5/8" contoured valance grids available
- Paintable or stainable wood jamb extensions (4 9/16" and 6 9/16")
- Factory mulling available
- Charcoal aluminum mesh screen
- Window Opening Control Device (for fall prevention)
- Almond and Clay Colors
- Black Exterior Laminate
- Nine Exterior Painted Colors (white interior only)
- Custom sizes available

Product Performance:

AAMA 101 Results:

Window Size	AAMA Rating (psf)	Air (cfm/ft ²)	Water (psf)
72" x 48"	HS-R30	0.09	4.59
108" x 60"	HS-R25	0.10	3.13

Product Dimensions:

Vinyl Wall Thickness:	0.065"
Glass Thickness:	0.750"
Jamb Depth:	3.277"
Nail Fin Setback:	1.5"

Rough Opening:

Window Width + 1/2"
Window Height + 1/2"

2-Lite Slider Size Restrictions:

	Min:	Max:
Width	23 1/2"	79 3/4"
Height	16 3/4"	73 3/4"
(Max. United Inches 132")		

3-Lite Slider Size Restrictions:

	Min:	Max:
Width	71 3/4"	141 1/2"
Height	16 3/4"	73 3/4"
Width restrictions for 1/3, 1/3, 1/3 configuration:		
	54"	108"
(Max. United Inches 158")		

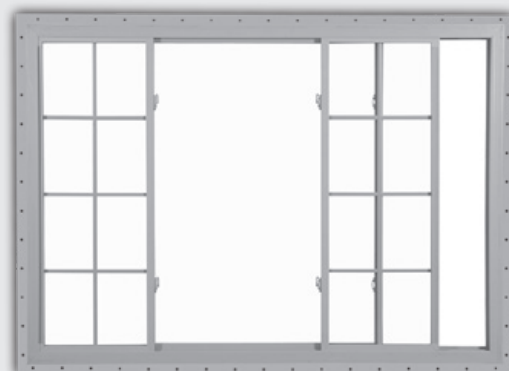

151/161 2 and 3-Lite Sliding Window

Egress Formulas:

Egress Width $\geq 20"$ and Egress Height $\geq 24"$ and Egress Area $\geq 5.7 \text{ ft}^2$ required to meet egress.

Egress Width Formula = $(\text{Window Width}/2) - 4"$ (XX)

$(\text{Window Width}/3) - 4"$ (XOX 1/3 1/3 1/3)

$(\text{Window Width}/4) - 2.25"$ (XOX 1/4 1/2 1/4)

Egress Height Formula = $\text{Window Height} - 4.875"$

Egress Area Formula = $(\text{Egress Width} \times \text{Egress Height})/144$

Screen Formulas:

$(\text{Window Width}/2) - 2.6875"$

$\text{Window Height} - 3.875"$

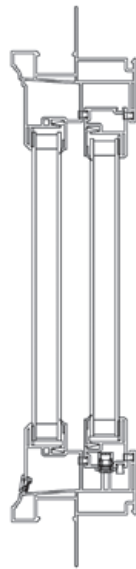

**Series
151
Vertical
Diagram**



**Series
161
Vertical
Diagram**

Series 151 2-Lite Horizontal Diagram

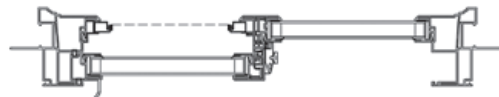

Series 151 3-Lite Horizontal Diagram

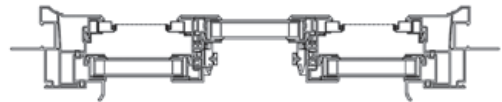

Series 161 2-Lite Horizontal Diagram

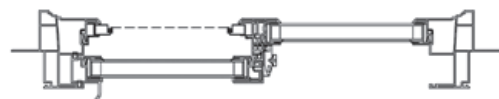

Series 161 3-Lite Horizontal Diagram



Series 151 Mullion Assembly:

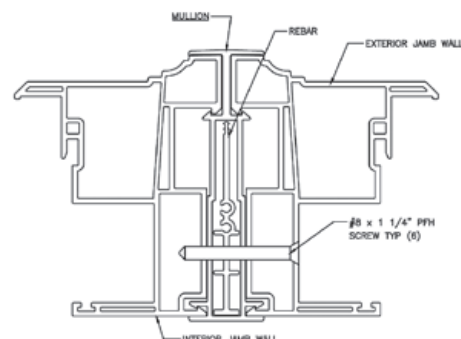

Series 161 Mullion Assembly:

